

# What if This Happened to YOU...



## or Your Loved One?

*A campaign for enhanced  
Emergency Medical Services*

# When YOU Call 911, They Call US!

**911 doesn't call the hospital or the doctors' offices – they call SEMS Paramedic Services.**

## Common 911 Calls

Will they affect you, your family, an employee or acquaintance?

Cardiovascular	Substance Abuse /Behavioral
Respiratory	Gastrointestinal
Traumatic Injury	Severe Pain
Altered Mental States	Stroke

## The present facility is limiting the ability to...

- Attract and retain volunteers
- Serve citizens
- Train staff
- Expand services

**Currently, SEMS is 25% short of optimum staffing!** A new facility can easily accommodate 30+ crew members. Critical Care Paramedics, Paramedics, Registered Nurses, AEMTs, EMTs, EMRs and support staff provide 911 and inter-facility care and transportation around the clock every day of the year.

**SEMS calls have increased 50%** since 2006 – yet the facilities haven't been substantially updated since the 1980s.

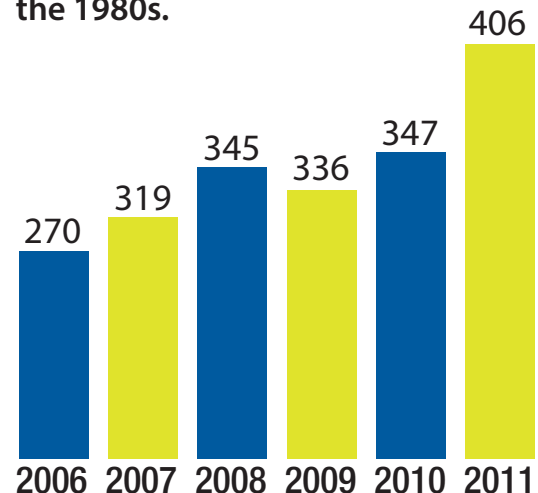

## "I'd love to volunteer, but..."

Ann Bock's story is one SEMS hears over and over again. Ann says, "I'd love to volunteer for a shift or two at SEMS, but since I live outside of the 5-minute zone... the current building doesn't allow for that."

New facilities would accommodate out-of-territory staff, like Ann, by providing on-call sleep rooms. Qualified, trained volunteers could take more shifts, alleviating strain on existing staff.

# 1 in 10 Served... Could it be YOU?

SEMS Paramedic Services provides care for ONE out of ten people in the primary service area each year. SEMS volunteers share stories of survivors of grain bin disasters, heart attacks, tragic vehicle crashes, emergency births and more. *Could the next SEMS call be about YOU?*

## Only Ambulance Service in Sumner

“One of Sumner’s most valuable assets in healthcare services is SEMS. I am a big supporter of SEMS and having good EMS in Sumner.”

Connie Leicher  
President, Life Line Emergency Vehicles

## 200 Square Miles Served

**Primary Service Area:** Sumner, Westgate plus rural Bremer, Fayette, and Chickasaw counties.

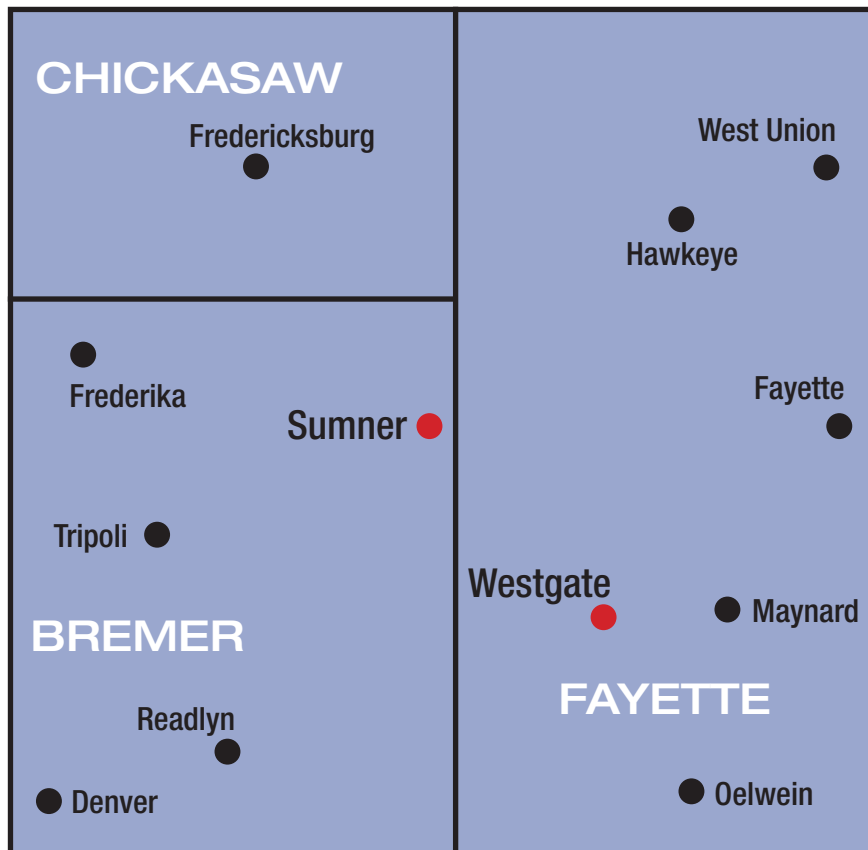

### “Because of SEMS, my wife is not a widow...”



Steve Reuter remembers it well. “In late January 2001, I became ill and passed out at home and my wife called 911.

“SEMS’ response was almost immediate and because of the protocol they went through, they came to a correct diagnosis. That’s another reason I believe I am here. SEMS had a protocol in place and were highly trained and very professional. It gave the surgeon and other doctors excellent information. I was told later that there are very few survivors with ruptured abdominal aneurysms.

“Because of SEMS, my wife is not a widow, my children still have a father, my grandchildren still have their grandpa and my great grandchildren know their great grandfather.”



# YOU Benefit from a New Facility

**Faster Response Times** Expand the SEMS crew with the addition of living quarters, allowing for personnel from outside of the area. Currently SEMS crew members must live within five minutes of the building.

**Expanded Service Area** Ability to serve an expanded region with added crew and ambulances. The integrated helicopter landing zone allows flexibility should CMH's landing zone be occupied or in the case of a tragedy requiring multiple helicopters.

**Improved Patient Outcomes** Strengthen the continuing medical education program through increased space and training opportunities for all area health care providers.

“ I want everybody to think long and hard about where they would be without an ambulance nearby. ”

Jim Niemann  
President, Paul Niemann Construction Company, Sumner  
Honorary Co-Chair, SEMS Capital Campaign

## More Community Outreach

SEMS' mobile response team is poised to fill a need for proactive community health services. These are some of those services:

- Wellness assessment
- Health risk assessment
- Walking and balance assessment
- Infant and child car seat clinics
- Sports injury prevention
- Home safety assessments



## Fast, Professional and Caring

Cherryl Cole was at her doctor's office for a routine treatment when she started to feel dizzy. Her blood pressure dropped dramatically and they couldn't get her heart rate up – so the doctor called 911!

A SEMS crew was there in minutes to help make a good ending out of what could have been a terrible event. Cherryl said, "The EMS people were so professional and they cared about me as a patient and as a person."

# A Reachable Goal

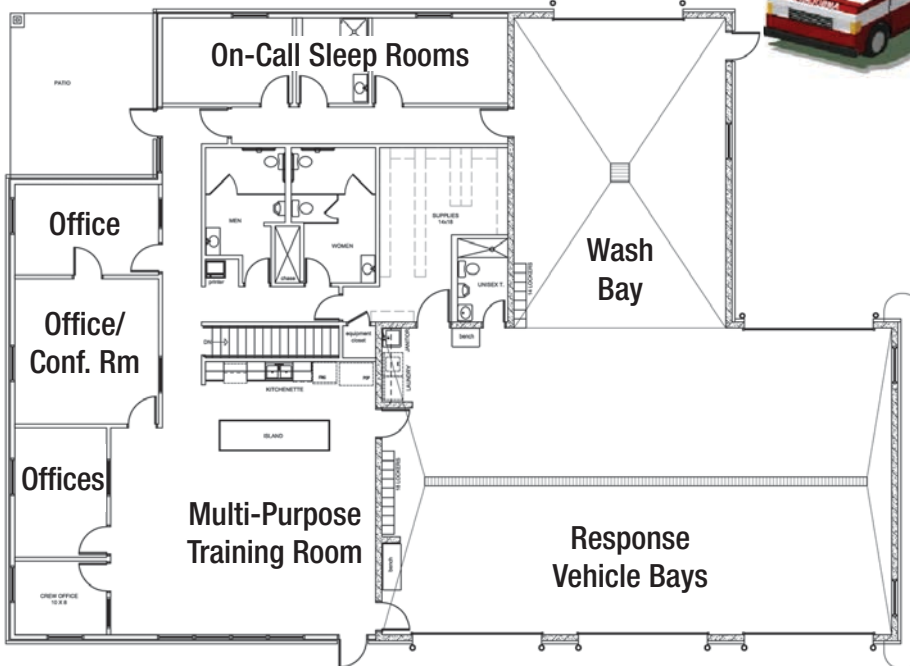

## Details of the new 7,000 sq. ft. facility;

- Three response vehicle bays plus wash area
- Multi-purpose training room that seats 60
- Kitchen and offices
- Rest rooms and shower facilities
- Crew living quarters
- Dedicated helicopter landing zone

## TRAINING Continual and Costly

*Constant, continuing education ensures quality patient care!* Hours of classroom and hands-on education must be invested for each Responder, EMT and Paramedic. Materials and travel (when required) add a budget burden to SEMS – a community based, not-for-profit corporation. Your financial support will help establish a training fund.

## \$1.5 Million Total Facility (\$1,400,000) and Training Cost (\$100,000)

“SEMS has no debt and they just bought a new ambulance with cash. It's a well-run organization worthy of your support.”

Greg Johnson  
President, First State Bank, Sumner  
Chair, SEMS Capital Campaign

# The 1<sup>st</sup> Rural Paramedic Service in Iowa!

## A Tradition of Leadership since 1983

The City of Sumner constructed the existing "ambulance garage" in 1983. Since then, little has changed with the building. However, during this same 30-year period, healthcare has evolved in nearly inconceivable ways and consumer expectations have become more sophisticated. These have combined to create a need for new and innovative thoughts, policies, procedures, training, staffing, and equipment.

SEMS crew circa 1980s



Today, rural paramedic services must be uniquely skilled and equipped to competently manage any patient in any situation. Emergencies may include:

- agricultural and industrial injuries • heart attacks • strokes • burns • vehicle crashes
- cardiac arrest • acts of terrorism • critical care transfers of patients to specialty hospitals.

The ability to quickly and appropriately manage patients in these sensitive situations requires an adequate number of highly trained, skilled, and motivated professionals ready to respond at a moment's notice.

***The future of exceptional mobile health services in our area depends on YOU.***



901 West First Street, PO Box 911, Sumner, Iowa 50674

**563.578.8888**

[www.sumnerems.com](http://www.sumnerems.com) [director@sumnerems.com](mailto:director@sumnerems.com)

Sumner Emergency Medical Services, Inc.



**Yes**

***I/we wish to support SEMS Paramedic Services!***

Name \_\_\_\_\_ Company \_\_\_\_\_

Address \_\_\_\_\_ City \_\_\_\_\_ State \_\_\_\_\_ Zip \_\_\_\_\_

Phone \_\_\_\_\_ Cell \_\_\_\_\_ E-mail \_\_\_\_\_

Total Commitment \$ \_\_\_\_\_ Paid Now \$ \_\_\_\_\_ Balance \$ \_\_\_\_\_

Balance to be paid ☐ annually ☐ quarterly ☐ other (please describe) \_\_\_\_\_

Commitments may be payable over three years. \_\_\_\_\_

Make checks payable to: SEMS Paramedic Services

***To donate online, go to: [sumnerems.com](http://sumnerems.com)***



901 West First Street, P0 Box 911, Sumner, Iowa 50674

**563.578.8888**

[www.sumnerems.com](http://www.sumnerems.com) *director@sumnerems.com*

*Sumner Emergency Medical Services, Inc.*



# Please continue SEMS' tradition of healthcare leadership and self-reliance.

SEMS is a community-based, not-for-profit corporation designated as a 501(c)4 by the Internal Revenue Service.

## Naming and Giving Opportunities

Facility Named	\$500,000
Multi-Purpose Training Room	\$125,000
Helicopter Landing Zone	\$100,000
Director's Office/Conf. Room	\$ 75,000
Offices (3 available)	\$ 50,000
Response Vehicle Bay (3 avail.)	\$ 40,000
Wash Bay	\$ 25,000
On-Call Sleep Rooms (2 avail.)	\$ 20,000
___ Paramedic Trainer	\$ 10,000
___ EMT Trainer	\$ 5,000
___ Responder Trainer	\$ 3,000

*Above gifts will be permanently recognized with donor approval. We welcome ways to make your tribute lasting and meaningful. All gifts are greatly appreciated and tax deductible.*

### Is your gift a tribute?

- ☐ In Living Honor of:
- ☐ In Memory of:

***Thank you for your gift!***