

FOR LEASE OR SALE:

2,649 Sq. Ft. Prime Office Suite
Libertyville Offices at Pine Meadow
900 Technology Way • Suite 270 • Libertyville • IL 60048

**PROPERTY HIGHLIGHTS:**

AVAILABLE SPACE: 2,649 Sq. Ft.
BUILDING TYPE: Office/Professional
BASE RENT: \$19.00 Sq. Ft. Gross
PURCHASE PRICE: \$125.00 Sq. Ft.
CEILING HEIGHT: 9'-6"
HVAC: Yes
PARKING: Ample Common, Non-Assigned
SPRINKLERED: Yes
AVAILABILITY: Now

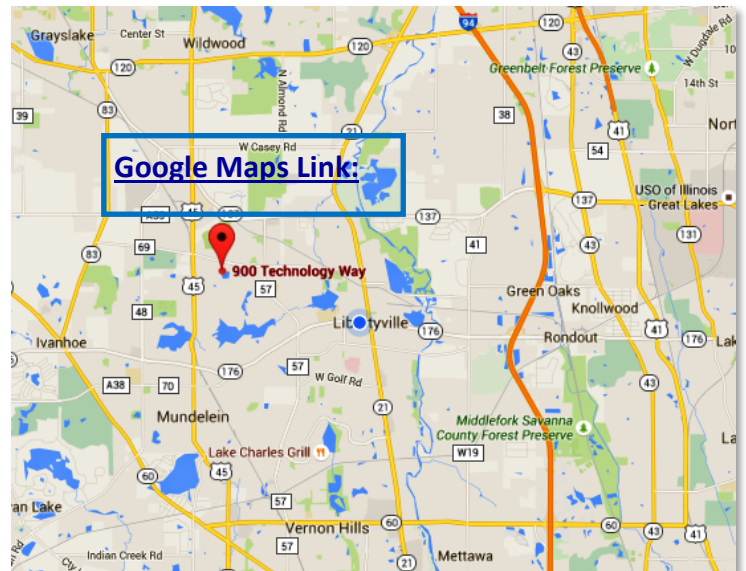

COMMENTS: Newly constructed office condo development in prime Libertyville location for professional business or medical user. Quality finishes throughout building. Corner location. Wonderful window line and views. Ample parking. Close in proximity to Condell Medical Center, Winchester Road, and Route 45. Easy access to I-94. This never-occupied suite offers an outstanding location with excellent access and exposure.

Contact: [Ralph Huszagh](#) @ 847-977-9040 (Cell) / jcf.ralph@sbcglobal.net

JC **FORNEY** INC
REALTY

Commercial / Industrial / Investment
Serving Lake County Since 1935

131 West Park Avenue • Libertyville • IL • 60048
www.jcforneyrealty.com
Office: (847) 362-2000
Fax: (847) 362-7341

All information contained herein is from sources deemed reliable and is submitted subject to errors, omissions, and change without notice

FOR LEASE OR SALE:

2,649 Sq. Ft. Prime Office Suites
Libertyville Offices at Pine Meadow
900 Technology Way • Suite 270 • Libertyville • IL 60048



1st Floor Lobby

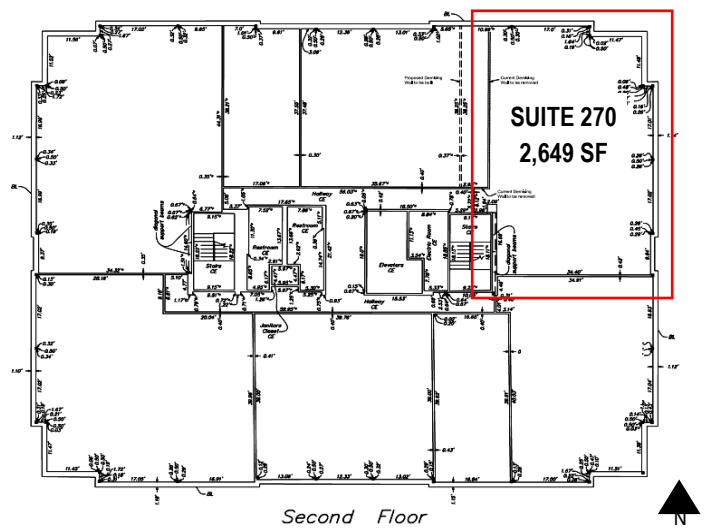

Contact: [Ralph Huszagh](mailto:jcf.ralph@sbcglobal.net) @ 847-977-9040 (Cell) / jcf.ralph@sbcglobal.net

JC **FORNEY** INC
REALTY

Commercial / Industrial / Investment
Serving Lake County Since 1935

131 West Park Avenue • Libertyville • IL • 60048
www.jcforneyrealty.com
Office: (847) 362-2000
Fax: (847) 362-7341

All information contained herein is from sources deemed reliable and is submitted subject to errors, omissions, and change without notice