

Axle Center

Cross members are 2x2x 1/8 thick
angle iron

84"
(D1)

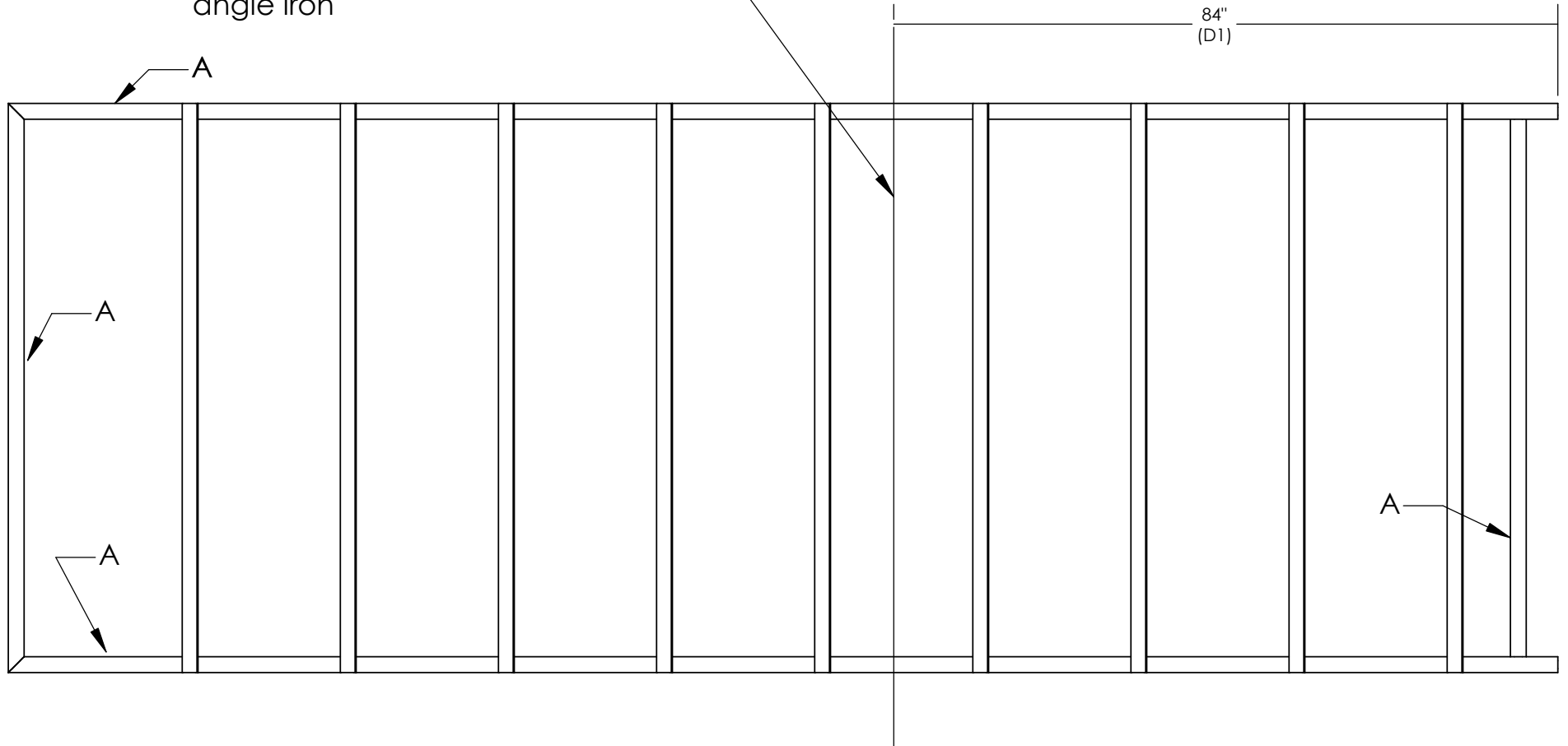

NOTE A : The primary out side frame is
2x2x .095 wall

www.tmanskarts.com

5

↑

4

3

2

1

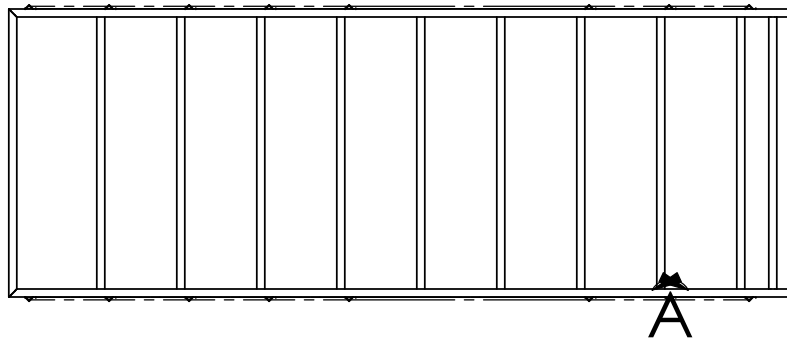

SIDE UP RIGHTS AND TOP
RAIL ARE MADE OF 1 1/2
ANGLE IRON

Side rail
angle iron
will be welded
on like this.

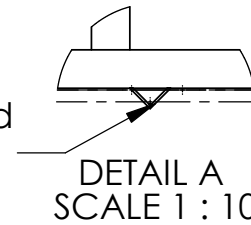

The side rails are 15 1/2
inches high. Cut 16

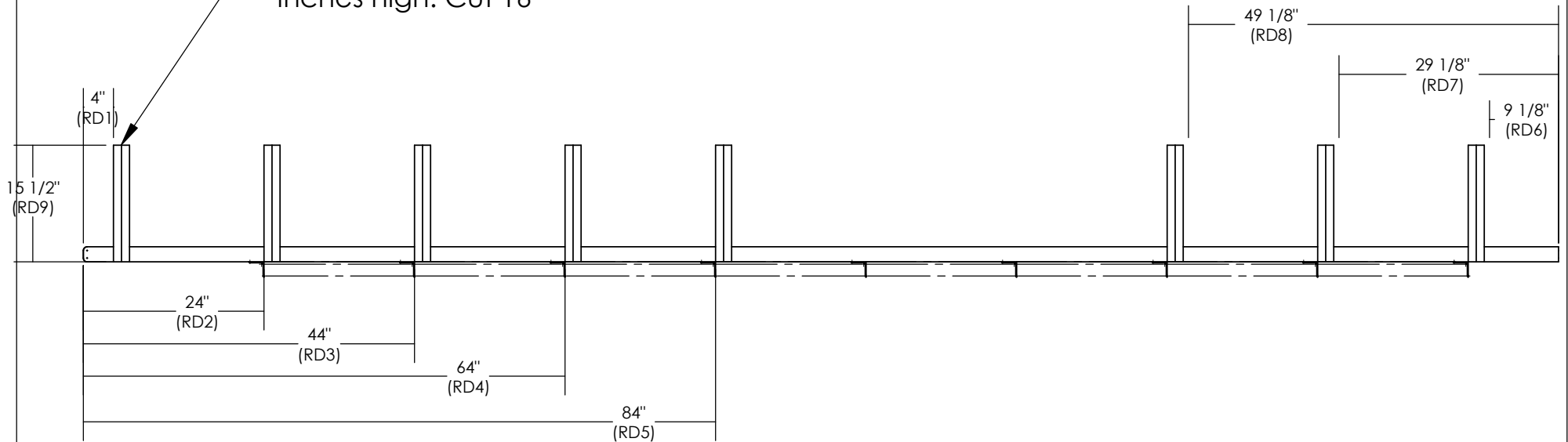

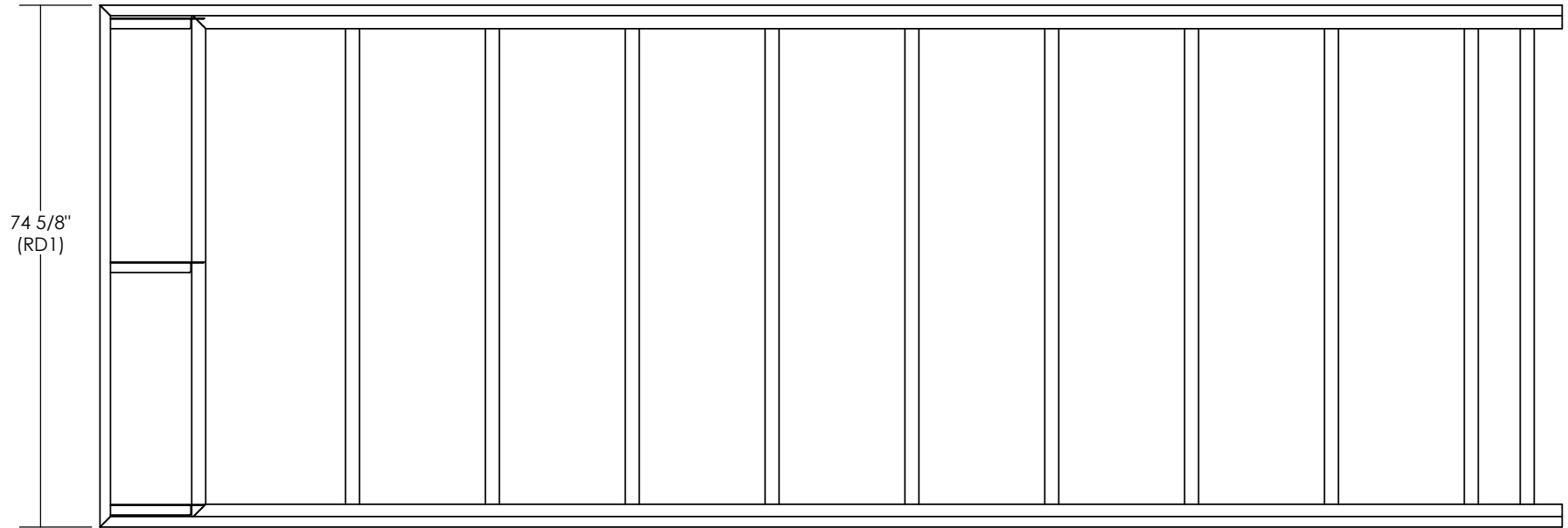

The top rail is 1 1/2 x 1 1/2 x 1/8 thick angle iron

Be sure to line up the top with the bottom

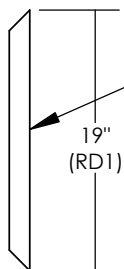
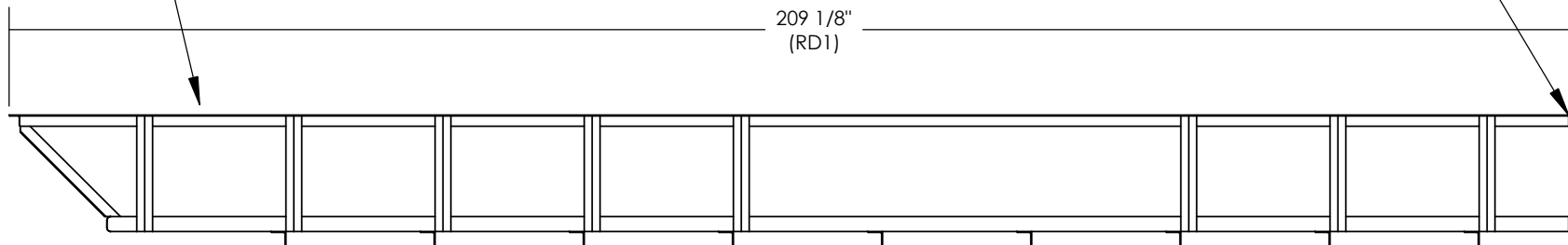

This is the front up right
this can be angle iron
or square tubing ...
both ends are cut at 45°
I used 3 in my build

www.tmanskarts.com

5

4

3

2

1

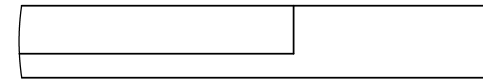
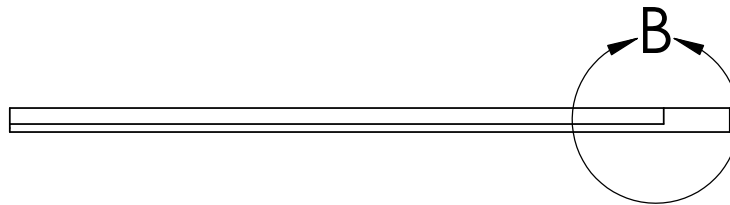

DETAIL B
SCALE 1 : 8

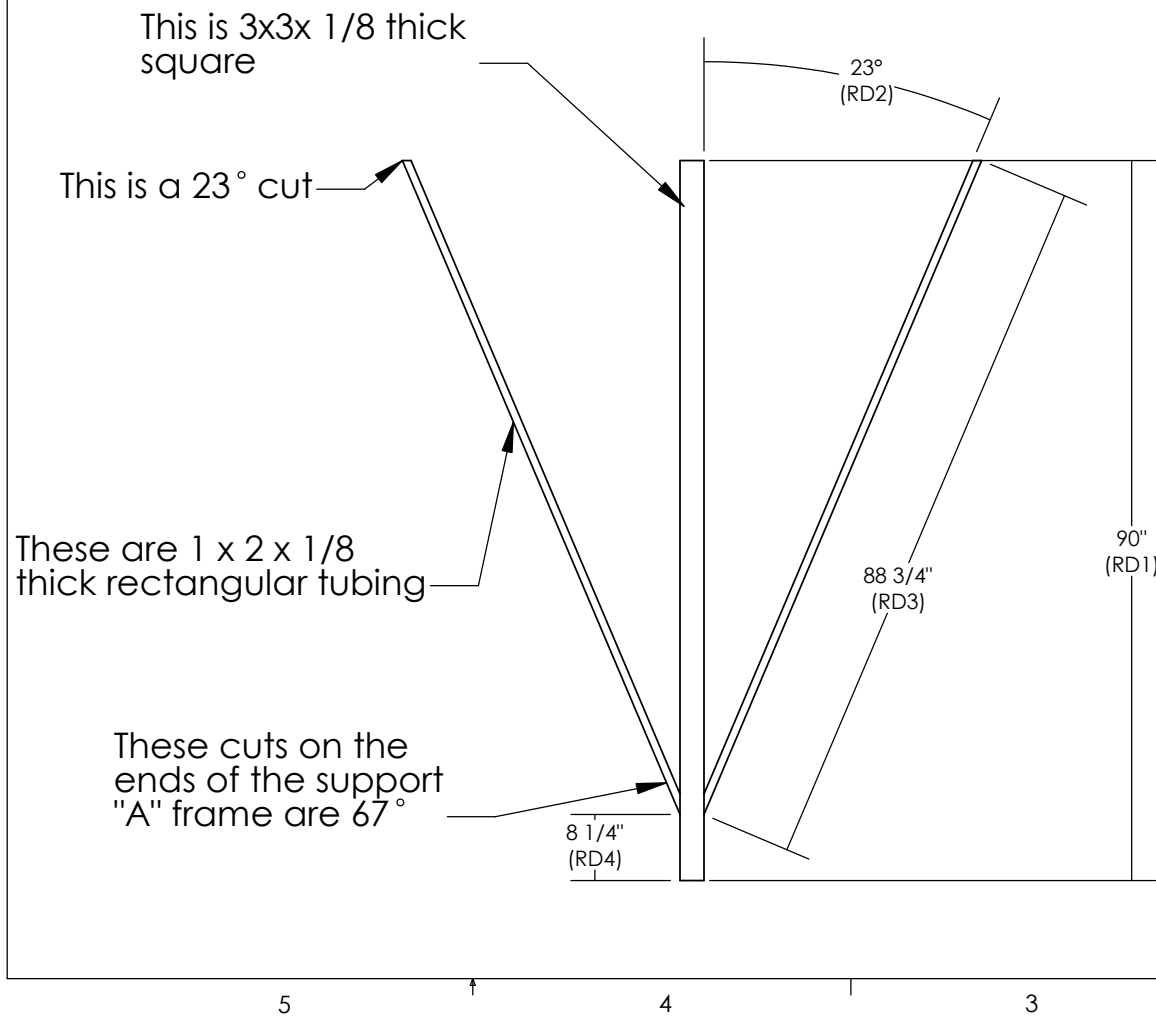

Note B : The cross member will have to be notched so the tongue and "A" support will fit.

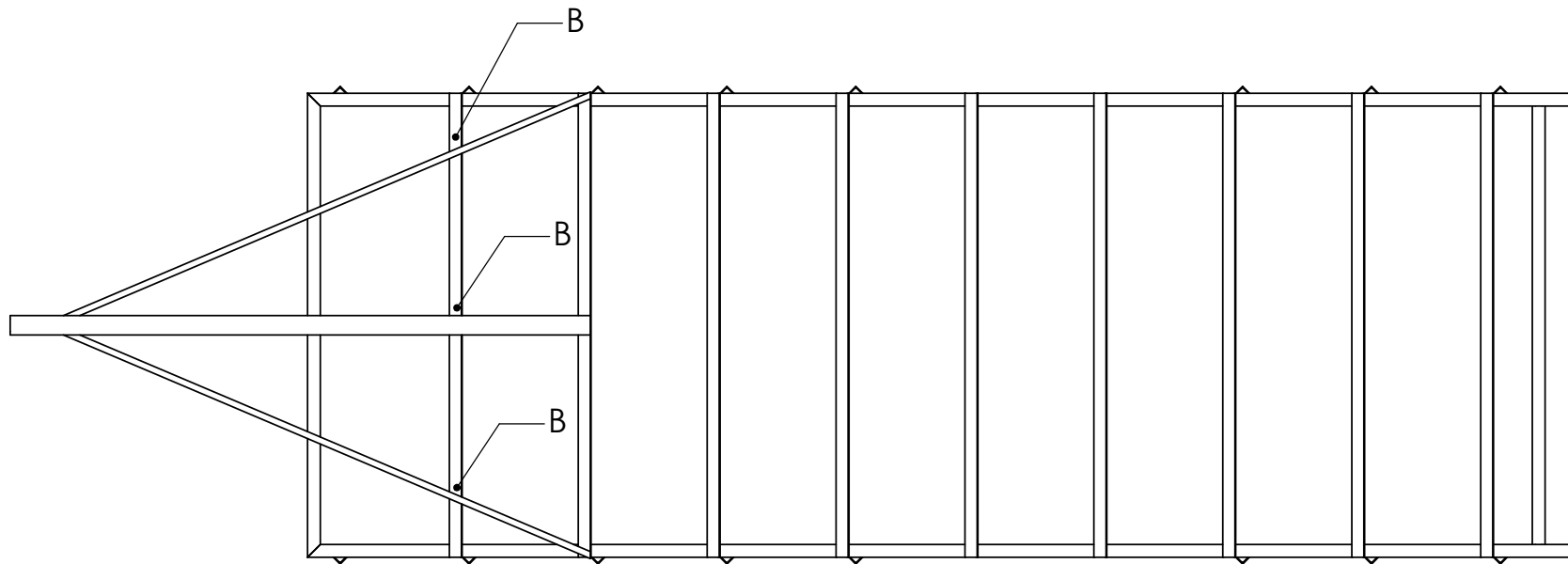
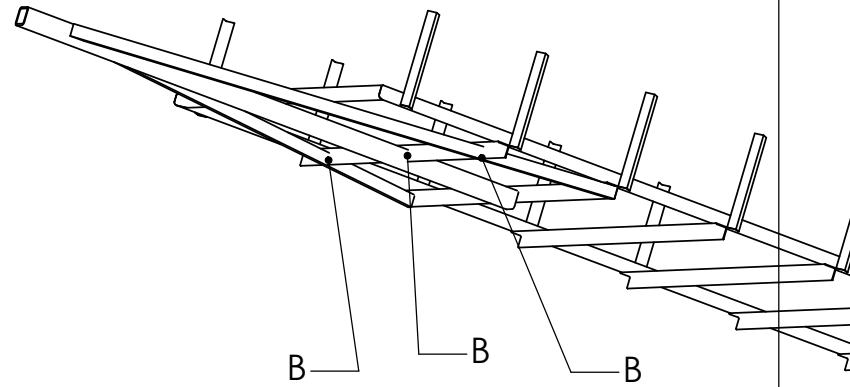

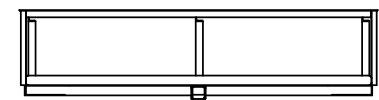
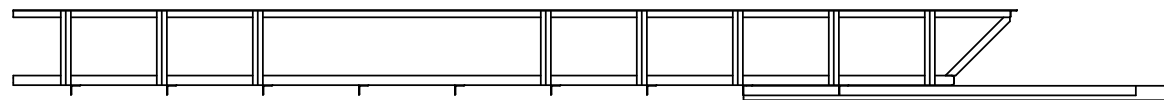
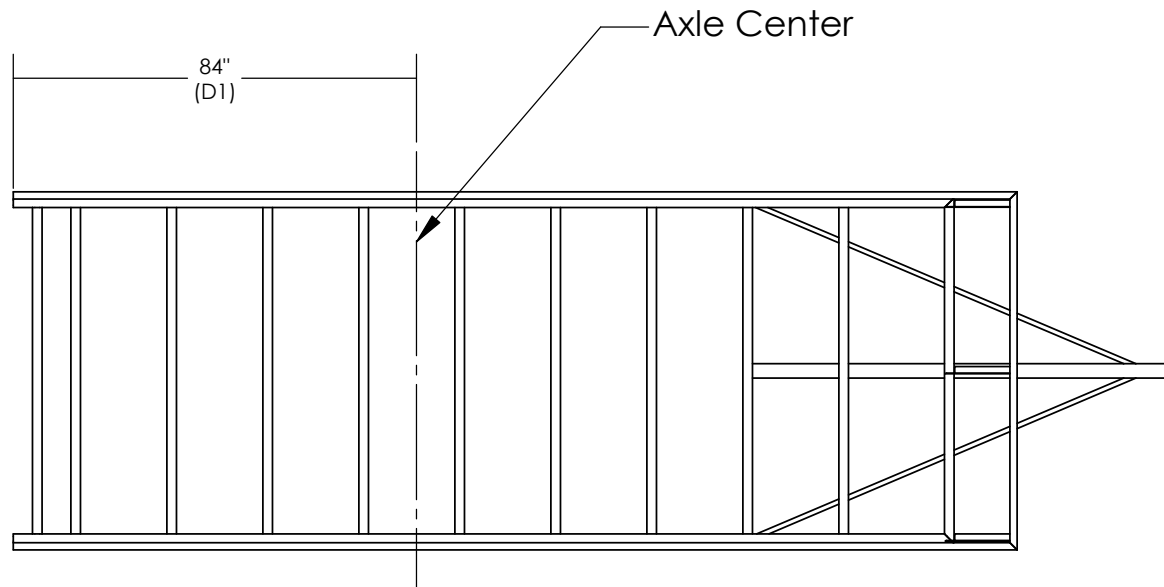

www.tmanskarts.com

5



4

3

2

1